



Product Item Numbers



Note: There are multiple selections to be made for this product. Begin by selecting the appropriate channel body length then proceed to grate selection accordingly, keeping in mind there two frame height options for the SOLID (A) and SQUARE (B) grates.

Schluter®-KERDI-LINE

CHANNEL BODY

Contents



1x
Channel body



4x
Inside corners



2x
Outside corners



1x
Channel support



1x
Pipe seal
(3/4" - 20 mm)



1x
Mixing valve seal
(4-1/2" - 114 mm)



1x
No-hub coupling

Channel body center outlet

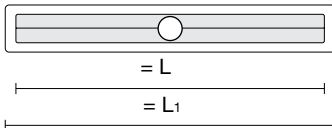

Schluter®-KERDI-LINE

Channel body - stainless steel - center outlet

L = in. - cm	L ₁ = in. - cm	Item No.
19-11/16 - 50	21-11/16 - 55	KL1V 60 E 50
23-5/8 - 60	25-5/8 - 65	KL1V 60 E 60
27-9/16 - 70	29-9/16 - 75	KL1V 60 E 70
31-1/2 - 80	33-1/2 - 85	KL1V 60 E 80
35-7/16 - 90	37-7/16 - 95	KL1V 60 E 90
39-3/8 - 100	41-3/8 - 105	KL1V 60 E 100
43-5/16 - 110	45-5/16 - 115	KL1V 60 E 110
47-1/4 - 120	49-1/4 - 125	KL1V 60 E 120
51-3/16 - 130	53-3/16 - 135	KL1V 60 E 130
55-1/8 - 140	57-1/8 - 145	KL1V 60 E 140
59-1/16 - 150	61-1/16 - 155	KL1V 60 E 150
62-15/16 - 160	64-15/16 - 165	KL1V 60 E 160
66-7/8 - 170	68-7/8 - 175	KL1V 60 E 170
70-13/16 - 180	72-13/16 - 185	KL1V 60 E 180

Channel body off-set outlet

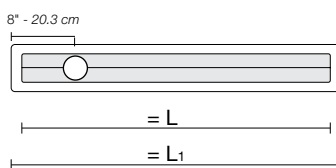

Channel body - stainless steel - off-set outlet

L = in. - cm	L ₁ = in. - cm	Item No.
27-9/16 - 70	29-9/16 - 75	KL1VO 60 E 70
31-1/2 - 80	33-1/2 - 85	KL1VO 60 E 80
35-7/16 - 90	37-7/16 - 95	KL1VO 60 E 90
39-3/8 - 100	41-3/8 - 105	KL1VO 60 E 100
43-5/16 - 110	45-5/16 - 115	KL1VO 60 E 110
47-1/4 - 120	49-1/4 - 125	KL1VO 60 E 120



Schluter®-KERDI-LINE

GRATE ASSEMBLY - BRUSHED STAINLESS STEEL

CONTENTS

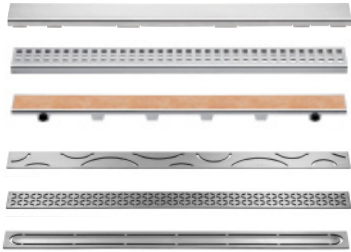

1x

- Grate
6 design options:
- SOLID
 - SQUARE
 - TILE
 - CURVE
 - FLORAL
 - PURE

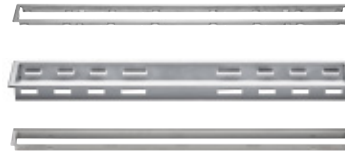

1x

Grate frame with height adjustment spacers. See product tables for frame height options (not included with TILE grate).

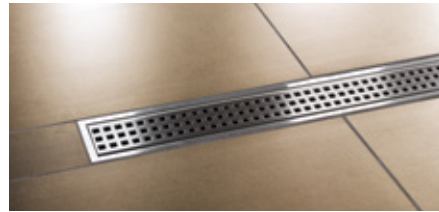
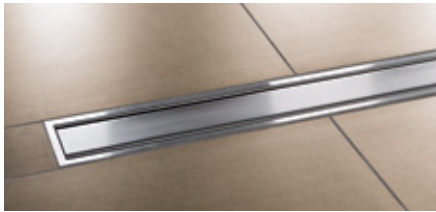

SOLID (A)

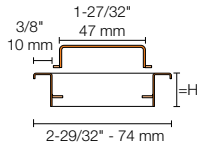

SQUARE (B)

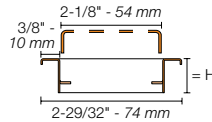

Grate assemblies - Brushed stainless steel

Length = in. - cm	3/4" (19 mm) frame height for 1/8" to 9/16" (3 mm to 15 mm) -thick coverings		
	SOLID (A) Item No.	SQUARE (B) Item No.	
19-11/16 - 50	KL1AR 19 EB 50	KL1B 19 EB 50	
23-5/8 - 60	KL1AR 19 EB 60	KL1B 19 EB 60	
27-9/16 - 70	KL1AR 19 EB 70	KL1B 19 EB 70	
31-1/2 - 80	KL1AR 19 EB 80	KL1B 19 EB 80	
35-7/16 - 90	KL1AR 19 EB 90	KL1B 19 EB 90	
39-3/8 - 100	KL1AR 19 EB 100	KL1B 19 EB 100	
43-5/16 - 110	KL1AR 19 EB 110	KL1B 19 EB 110	
47-1/4 - 120	KL1AR 19 EB 120	KL1B 19 EB 120	
51-3/16 - 130	KL1AR 19 EB 130	KL1B 19 EB 130	
55-1/8 - 140	KL1AR 19 EB 140	KL1B 19 EB 140	
59-1/16 - 150	KL1AR 19 EB 150	KL1B 19 EB 150	
62-15/16 - 160	KL1AR 19 EB 160	KL1B 19 EB 160	
66-7/8 - 170	KL1AR 19 EB 170	KL1B 19 EB 170	
70-13/16 - 180	KL1AR 19 EB 180	KL1B 19 EB 180	
Length = in. - cm	1-1/8" (30 mm) frame height for 1/2" to 1" - (13 mm to 25 mm) -thick coverings		
	19-11/16 - 50	KL1AR 30 EB 50	KL1B 30 EB 50
	23-5/8 - 60	KL1AR 30 EB 60	KL1B 30 EB 60
	27-9/16 - 70	KL1AR 30 EB 70	KL1B 30 EB 70
	31-1/2 - 80	KL1AR 30 EB 80	KL1B 30 EB 80
	35-7/16 - 90	KL1AR 30 EB 90	KL1B 30 EB 90
	39-3/8 - 100	KL1AR 30 EB 100	KL1B 30 EB 100
43-5/16 - 110	KL1AR 30 EB 110	KL1B 30 EB 110	
47-1/4 - 120	KL1AR 30 EB 120	KL1B 30 EB 120	



Schluter®-KERDI-LINE

GRATE ASSEMBLY - CHROME

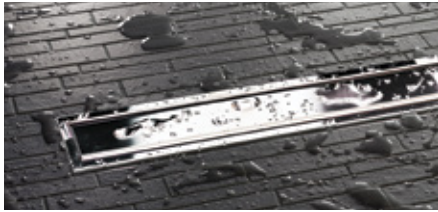

SOLID (A)

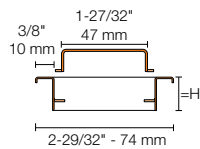

SQUARE (B)

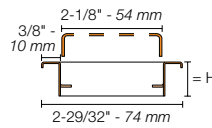

Grate assemblies - Chrome			
3/4" (19 mm) frame height for 1/8" to 9/16" (3 mm to 15 mm) -thick coverings			
Length = in. - cm	SOLID (A)		SQUARE (B)
	Item No.		Item No.
19-11/16 - 50	KL1AR 19 EP 50	KL1B 19 EP 50	
23-5/8 - 60	KL1AR 19 EP 60	KL1B 19 EP 60	
27-9/16 - 70	KL1AR 19 EP 70	KL1B 19 EP 70	
31-1/2 - 80	KL1AR 19 EP 80	KL1B 19 EP 80	
35-7/16 - 90	KL1AR 19 EP 90	KL1B 19 EP 90	
39-3/8 - 100	KL1AR 19 EP 100	KL1B 19 EP 100	
43-5/16 - 110	KL1AR 19 EP 110	KL1B 19 EP 110	
47-1/4 - 120	KL1AR 19 EP 120	KL1B 19 EP 120	

GRATE ASSEMBLY - FRAMELESS TILEABLE



TILE (D)

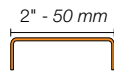

Grate assemblies - Frameless tileable			
Length = in. - cm	Item No.		
	TILE (D)		
	For use with center outlet channel body	For use with off-set outlet channel body	
19-11/16 - 50	KL1DRE 50	-	
23-5/8 - 60	KL1DRE 60	-	
27-9/16 - 70	KL1DRE 70	KL1DRO E 70	
31-1/2 - 80	KL1DRE 80	KL1DRO E 80	
35-7/16 - 90	KL1DRE 90	KL1DRO E 90	
39-3/8 - 100	KL1DRE 100	KL1DRO E 100	
43-5/16 - 110	KL1DRE 110	KL1DRO E 110	
47-1/4 - 120	KL1DRE 120	KL1DRO E 120	
51-3/16 - 130	KL1DRE 130	-	
55-1/8 - 140	KL1DRE 140	-	
59-1/16 - 150	KL1DRE 150	-	
62-15/16 - 160	KL1DRE 160	-	
66-7/8 - 170	KL1DRE 170	-	
70-13/16 - 180	KL1DRE 180	-	



GRATE ASSEMBLY - MATTE BLACK

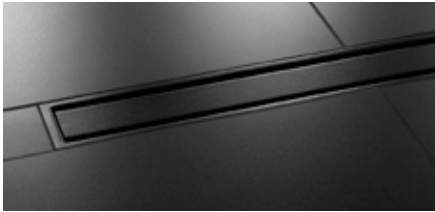

SOLID (A)

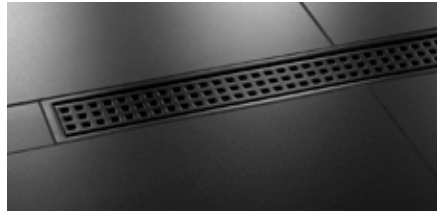
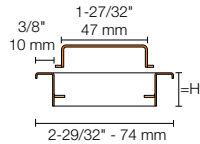

SQUARE (B)

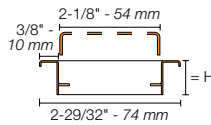

Grate assemblies - Matte black



19 mm - **3/4"** frame height for
3 mm to 15 mm - **1/8" to 9/16"** -thick coverings

Length = cm - in.	SOLID (A)	SQUARE (B)
	Item No.	Item No.
50 - 19-11/16	KL1AR 19 MGS 50	KL1B 19 MGS 50
60 - 23-5/8	KL1AR 19 MGS 60	KL1B 19 MGS 60
70 - 27-9/16	KL1AR 19 MGS 70	KL1B 19 MGS 70
80 - 31-1/2	KL1AR 19 MGS 80	KL1B 19 MGS 80
90 - 35-7/16	KL1AR 19 MGS 90	KL1B 19 MGS 90
100 - 39-3/8	KL1AR 19 MGS 100	KL1B 19 MGS 100
110 - 43-5/16	KL1AR 19 MGS 110	KL1B 19 MGS 110
120 - 47-1/4	KL1AR 19 MGS 120	KL1B 19 MGS 120
130 - 51-3/16	KL1AR 19 MGS 130	KL1B 19 MGS 130
140 - 55-1/8	KL1AR 19 MGS 140	KL1B 19 MGS 140
150 - 59-1/16	KL1AR 19 MGS 150	KL1B 19 MGS 150
160 - 62-15/16	KL1AR 19 MGS 160	KL1B 19 MGS 160
170 - 66-7/8	KL1AR 19 MGS 170	KL1B 19 MGS 170
180 - 70-13/16	KL1AR 19 MGS 180	KL1B 19 MGS 180



Schluter®-KERDI-LINE-STYLE

GRATE ASSEMBLY - BRUSHED STAINLESS STEEL STYLE DESIGNS

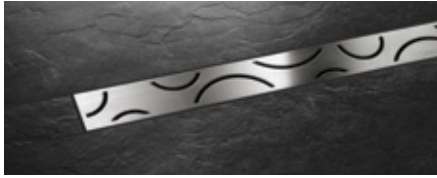

CURVE

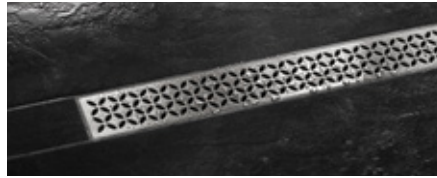
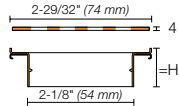

FLORAL

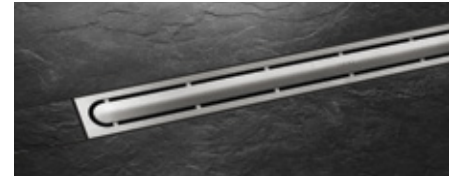
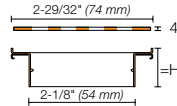

PURE

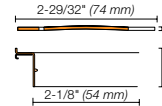

Grate assemblies - Brushed stainless steel



29/32" - 23 mm frame height for 1/4" - 11/16" (6 - 18 mm) -thick coverings

Length = in. - cm	CURVE ¹	FLORAL ²	PURE ³
	Item No.	Item No.	Item No.
19-11/16 - 50	KL1IFF 23 EB 50	KL1IFE 23 EB 50	KL1IFG 23 EB 50
23-5/8 - 60	KL1IFF 23 EB 60	KL1IFE 23 EB 60	KL1IFG 23 EB 60
27-9/16 - 70	KL1IFF 23 EB 70	KL1IFE 23 EB 70	KL1IFG 23 EB 70
31-1/2 - 80	KL1IFF 23 EB 80	KL1IFE 23 EB 80	KL1IFG 23 EB 80
35-7/16 - 90	KL1IFF 23 EB 90	KL1IFE 23 EB 90	KL1IFG 23 EB 90
39-3/8 - 100	KL1IFF 23 EB 100	KL1IFE 23 EB 100	KL1IFG 23 EB 100
43-5/16 - 110	KL1IFF 23 EB 110	KL1IFE 23 EB 110	KL1IFG 23 EB 110
47-1/4 - 120	KL1IFF 23 EB 120	KL1IFE 23 EB 120	KL1IFG 23 EB 120

1. U.S. Patent No. D831,168 2. U.S. Patent No. D831,170 3. U.S. Patent No. D831,169



Schluter®-KERDI-LINE

PERFORATED GRATE WITH LOCKING MECHANISM

The **Schluter®-KERDI-LINE SQUARE** grate assembly (B) with 3/4" (19 mm) frame height is available with a locking mechanism for applications where tamper resistance is required.

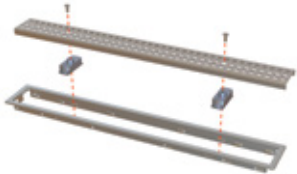

Length = in. - cm		Item No.
19-11/16	- 50	KL1BL 19 EB 50
23-5/8	- 60	KL1BL 19 EB 60
27-9/16	- 70	KL1BL 19 EB 70
31-1/2	- 80	KL1BL 19 EB 80
35-7/16	- 90	KL1BL 19 EB 90
39-3/8	- 100	KL1BL 19 EB 100
43-5/16	- 110	KL1BL 19 EB 110
47-1/4	- 120	KL1BL 19 EB 120
51-3/16	- 130	KL1BL 19 EB 130
55-1/8	- 140	KL1BL 19 EB 140
59-1/16	- 150	KL1BL 19 EB 150
62-15/16	- 160	KL1BL 19 EB 160
66-7/8	- 170	KL1BL 19 EB 170
70-13/16	- 180	KL1BL 19 EB 180

Note: Driver bit for tamper-proof screws sold separately.

COVER PLATE

Schluter®-KERDI-LINE-FC

Schluter®-KERDI-LINE-FC is a stainless steel cover plate for use with the Schluter®-KERDI-LINE linear floor drain to create a seamless look in applications where multiple drains are installed end to end. KERDI-LINE-FC is designed for use with either the SOLID or SQUARE grates.

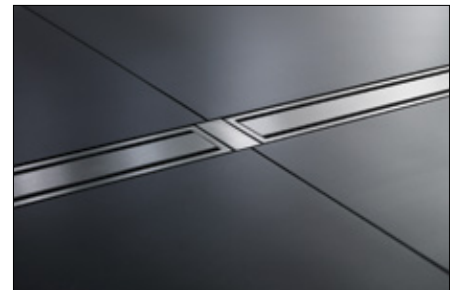
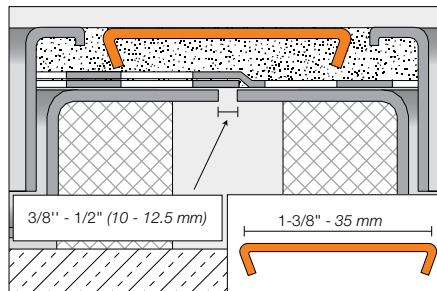
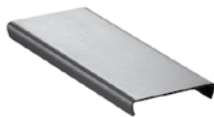

Schluter®-KERDI-LINE-FC Cover Plate		
Brushed stainless steel	Chrome	Matte black
Item No.	Item No.	Item No.
V / KLEB 35	V / KLEP 35	V / KLMGS 35

STRAINER

The **Schluter®-KERDI-LINE Strainer** is a hair catcher customized to fit inside the KERDI-LINE channel body to trap and collect hair. Simple to remove and clean, the hair catcher fits discreetly into the drain to prevent hair clogs that can lead to blocked pipes.



Strainer for KERDI-LINE	
Item No.	Description
KL VZ SF	Strainer